

Radioguide VOX N100 Tourguide system



Radioguide VOX N100 Tourguide system

SPECIFICATION

General

Frequency Range	472.025MHz-474.5MHz
Channels	100
Frequency Interval	25KHz
Working Temperature	-10°C ~ +60°C

Transmitter

Power Output	<10mW
Frequency Stability	<+/-25ppm
Modulation	FM
Max Deviation	+/-5.0KHz
FM noise	>45dB
Distortion	<3%
Power supply	2x AA batteries
Dimensions(WxDxH)	100x65x28mm
Weight	96.5g
MIC type	condenser

Receiver

Circuit	superheterodyne
IF	38.85MHz & 455KHz
Sensitivity	(12dB SINAD)< 0.45uV
Adjacent channel selectivity	>70dB
Intermodulation	>70dB
Spurious Emission	>70dB
Image rejection	>70dB
S/N	>45dB
Audio output	50mW @ 32Ω 5% THD
Power supply	2x AA batteries
Dimensions(WxDxH)	100x55x16mm
Weight	58g

PARTS DESCRIPTION

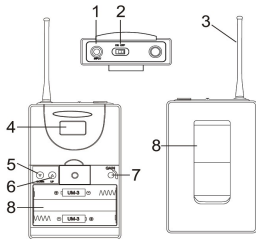

Transmitter

1. MIC in jack
2. Power switch
3. Antenna
4. LCD screen
5. CH DOWN
6. CH UP
7. Gain control: turn clockwise to increase transmitting power
8. Battery compartment
9. Clip

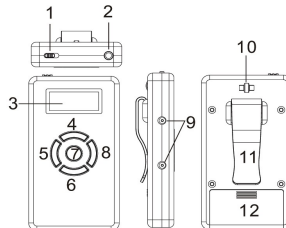

Receiver

1. Hold: Move to right to lock the functions of other buttons.
2. Phone jack
3. LCD screen
4. CH UP
5. Volume -
6. CH DOWN
7. Power switch: press and hold to turn on/off receiver
8. Volume +
9. Charging jack
10. Lanyard hole
11. Clip
12. Battery cover/compartment

Radioguide VOX N100 Tourguide system

OPERATING INSTRUCTIONS

Transmitter

1. Open battery cover and insert 2PCS 1.5V AA batteries or 1.2V rechargeable batteries, observing proper battery polarity.
2. Turn the power switch on top of the transmitter to ON position. LCD screen will light and display channel number and battery indicator.
3. Use UP, DOWN buttons in the battery compartment to adjust the frequency.
4. If you want to increase the transmitting power, turn GAIN control clockwise.
5. Plug the microphone cord into the MIC IN jack on top of the transmitter.
6. Position the Headset Microphone boom as close to the wearer's mouth as possible without actually touching. Lapel Clip microphones should be attached to a collar or lapel, as close to the wearer's mouth as possible.
7. If battery indicator in LCD screen shows low battery, please change new battery. If rechargeable battery is used, take it out and recharge the battery.
8. The transmitter can be placed in a pants pocket, or clipped onto a belt or waistband.

Receiver

1. Open battery cover and insert 2PCS 1.5V AA batteries or 1.2V rechargeable batteries, observing proper battery polarity. And then close the cover.
2. Plug the earphone or headphone into the PHONE jack on top of the receiver.
3. Place the headphones over your ears or earphones into your ears.
4. Press and hold power button to turn on receiver. Receiver LCD screen will light and display channel no., RF signal and battery power.
5. Press CH-UP or CH-DOWN to adjust receiver channel to to be same as transmitter.
6. Press volume + or - to adjust receiver volume to a comfortable listening level.
7. To lock the function buttons, switch HOLD buttons to right.
8. When receiver LCD screen shows low battery, please change new battery. If rechargeable battery is used, you can charge the receiver without taking the battery out with the charging station we provide separately. One charging station can charge 48 receivers at the same time.
9. Place the receiver in a pants pocket or clipped onto a belt, harness, or waistband or hang around your neck with the lanyard provided.

Make sure the transmitter and receiver are turned OFF when not in use. Take out the batteries from transmitter and receiver if you are not going to use this tour guide system for a long period of time.

